

# ES SERIES

## RELAY SOCKETS

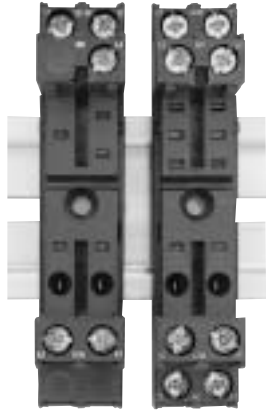

### DESCRIPTION

5 and 8 Pin Slim Line Sockets, DIN Rail Mountable, Finger Safe

### ELECTRICAL RATING

• 300 Volts, 10 Amps ; 300 Volts, 12 Amps

### CONSTRUCTION

**Contacts** • Brass, Nickel Plated  
**Screws** • M3 Steel, Nickel Plated, Maximum Wire Gauge #14  
**Molding** • Break Resistant Thermoplastic

### AGENCY APPROVALS

• UL recognized, File No. E113714   
 • CSA certified, File No. LR26716   
 • CE

### ORDERING CODE

PART NO.	DESCRIPTION	TERMINAL TYPE
ES35	SPDT, 5 Pin Slim Line (Fig. 1)	Box Lug
ES50	DPDT, 8 Pin Slim Line (Fig. 2)	Box Lug

### ACCESSORIES

**PART NO. DESCRIPTION** (Refer to the accessories pages 25-27)

C-103-PM	Prepunched Aluminum DIN Rail (1 Meter Lengths)
C-104-PM	Prepunched Steel DIN Rail (1 Meter Lengths)
C-105-PM	Prepunched Steel DIN Rail (1 Meter Lengths)
C-106-2PM	Prepunched Steel DIN Rail (2 Meter Lengths)
MS12	Hold Down Spring/Ejector
MS16	Hold Down Spring/Ejector
MS25	Hold Down Spring/Ejector

### PLUG-IN INDICATOR AND PROTECTION MODULES

PART NO.	DESCRIPTION
Type 22	Diode for 6-230V DC (+Terminal A1)
Type 42V	Green LED with Diode for 6-24V DC (+ Terminal A1)
Type 42CV	Green LED with Diode for 110-230V DC (+ Terminal A1)
Type 52B	RC Circuit for 6-24V AC
Type 52C	RC Circuit for 110-240V AC
Type 62V	Green LED for 6-24V AC/DC (For DC + Terminal A1)
Type 92V	Green LED for 110-240V AC/DC (For DC + Terminal A1)
Type 62CV	Varistor + Green LED for 6-24V AC/DC (For DC + Terminal A1)
Type 92CV	Varistor + Green LED for 110-240V AC/DC (For DC + Terminal A1)
Type 102	Bypass Resistor 110-240V AC

Fig. 1

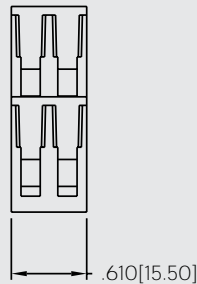
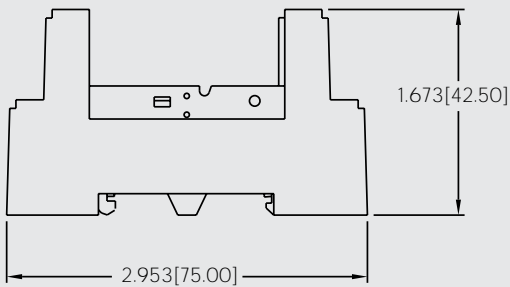
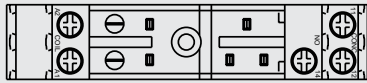

#### TERMINAL LOCATION

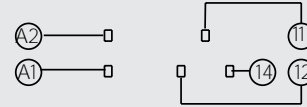

TOP VIEW

Fig. 2

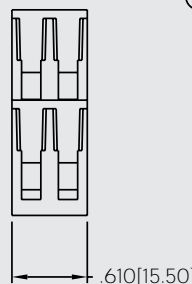
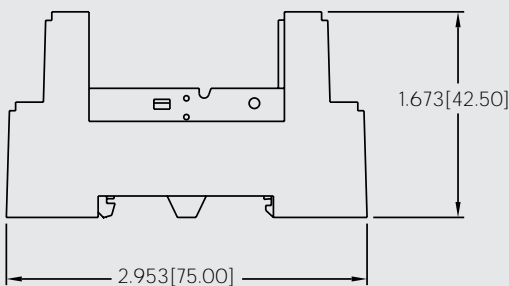
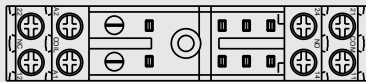

#### TERMINAL LOCATION

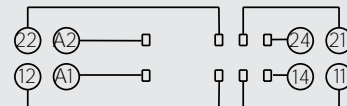

TOP VIEW

# ES SERIES

## RELAY SOCKETS

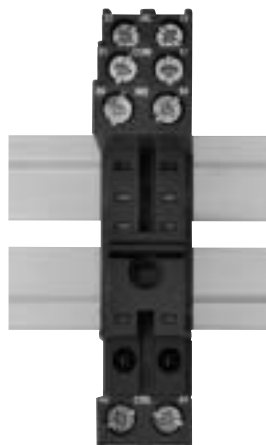

**NEW PRODUCT!**

<b>DESCRIPTION</b>	8 Pin Slim Line Sockets, DIN Rail Mountable, Finger Safe
<b>ELECTRICAL RATING</b>	• 300 Volts, 10 Amps  ; 300 Volts, 12 Amps
<b>CONSTRUCTION</b>	<b>Contacts</b> • Brass, Nickel Plated <b>Screws</b> • M3 Steel, Nickel Plated, Maximum Wire Gauge #14 <b>Molding</b> • Break Resistant Thermoplastic
<b>AGENCY APPROVALS</b>	• UL recognized, File No. E113714 • CSA certified, File No. LR26716 • CE

### ORDERING CODE

PART NO.	DESCRIPTION	TERMINAL TYPE
ES50/3	DPDT, 8 Pin Slim Line	Box Lug

### ACCESSORIES

PART NO.	DESCRIPTION (Refer to the accessories pages 25-27)
C-103-PM	Prepunched Aluminum DIN Rail (1 Meter Lengths)
C-104-PM	Prepunched Steel DIN Rail (1 Meter Lengths)
C-105-PM	Prepunched Steel DIN Rail (1 Meter Lengths)
C-106-2PM	Prepunched Steel DIN Rail (2 Meter Lengths)
MS12	Hold Down Spring/Ejector
MS16	Hold Down Spring/Ejector
MS25	Hold Down Spring/Ejector



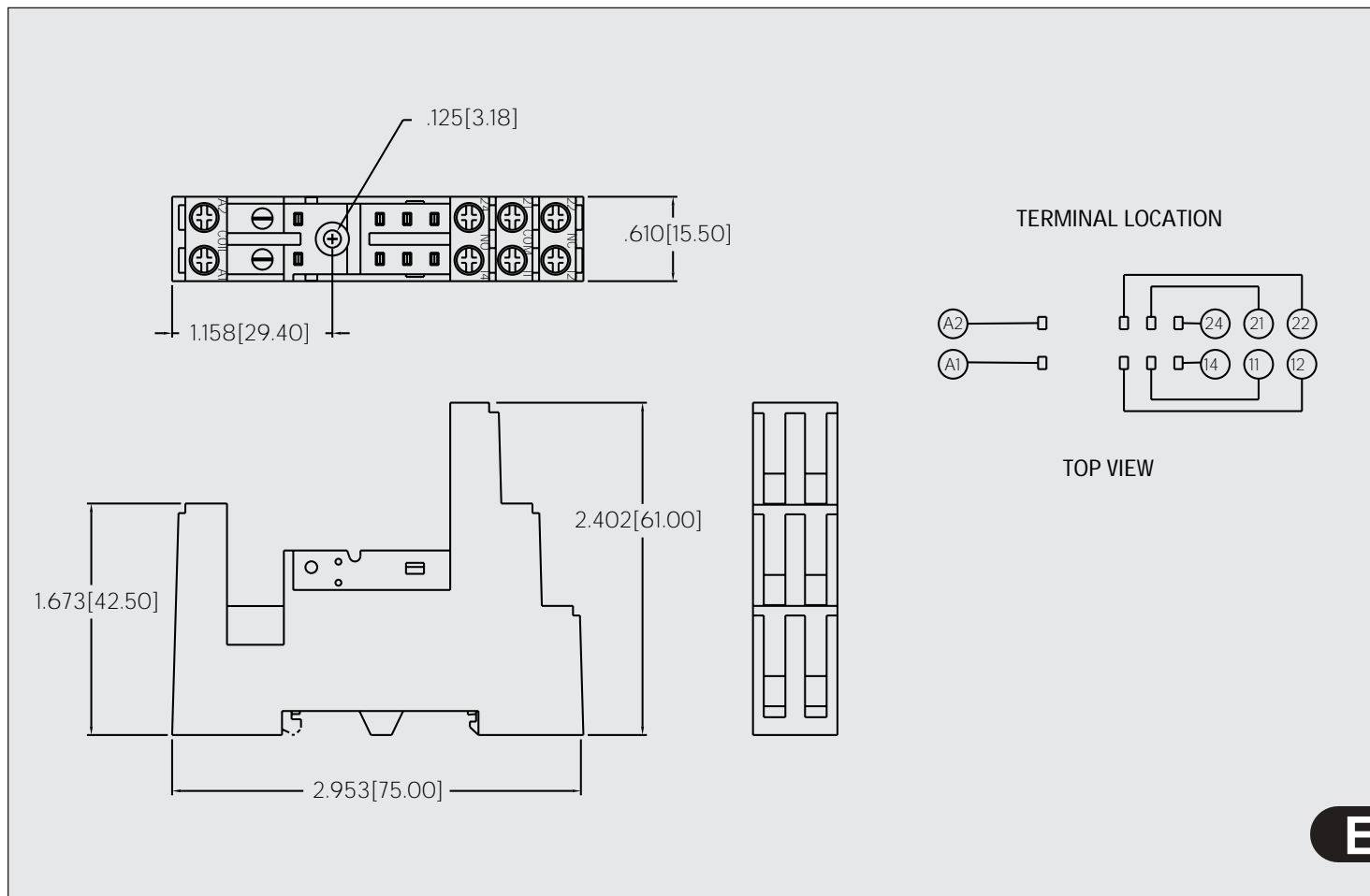

### PLUG-IN INDICATOR AND PROTECTION MODULES

PART NO.	DESCRIPTION
Type 22	Diode for 6-230V DC (+Terminal A1)
Type 42V	Green LED with Diode for 6-24V DC (+ Terminal A1)
Type 42CV	Green LED with Diode for 110-230V DC (+ Terminal A1)
Type 52B	RC Circuit for 6-24V AC
Type 52C	RC Circuit for 110-240V AC
Type 62V	Green LED for 6-24V AC/DC (For DC + Terminal A1)
Type 92V	Green LED for 110-240V AC/DC (For DC + Terminal A1)
Type 62CV	Varistor + Green LED for 6-24V AC/DC (For DC + Terminal A1)
Type 92CV	Varistor + Green LED for 110-240V AC/DC (For DC + Terminal A1)
Type 102	Bypass Resistor 110-240V AC



# EC SERIES

## RELAY SOCKETS

<b>DESCRIPTION</b>	5 and 8 Pin Slim Line Sockets
<b>ELECTRICAL RATING</b>	• 300 Volts, 10 Amps  ; 300 Volts, 12 Amps 
<b>CONSTRUCTION</b>	<b>Contacts</b> • Copper Alloy, Tin Plated <b>Molding</b> • Break Resistant Thermoplastic
<b>AGENCY APPROVALS</b>	• UL recognized, File No. E113714  • CSA certified, File No. LR26716  • CE 

### ORDERING CODE

PART NO.	DESCRIPTION	TERMINAL TYPE
EC35	SPDT, 5 Pin Slim Line (Fig. 1)	PC Board
EC50	DPDT, 8 Pin Slim Line (Fig. 2)	PC Board

### ACCESSORIES

PART NO.	DESCRIPTION (Refer to the accessories pages 25-27)
MH12-2	Hold Down Spring Steel
MH16-2	Hold Down Spring Steel
MH25-2	Hold Down Spring Steel
MP12-2	Hold Down Spring Plastic.....NEW!
MP16-2	Hold Down Spring Plastic.....NEW!
MP25-2	Hold Down Spring Plastic.....NEW!

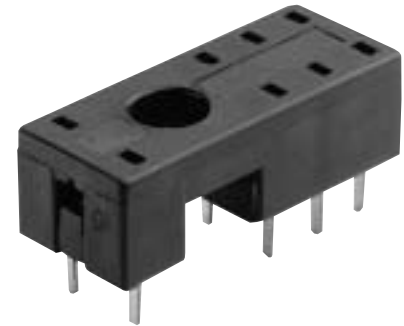

**Fig. 1**

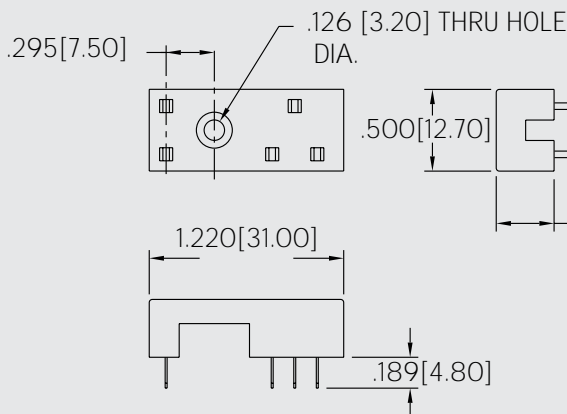

**PC BOARD LAYOUT**

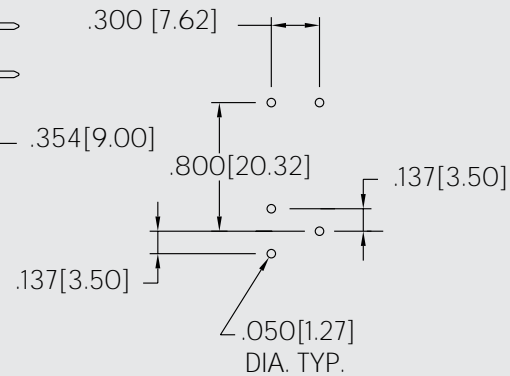

**Fig. 2**

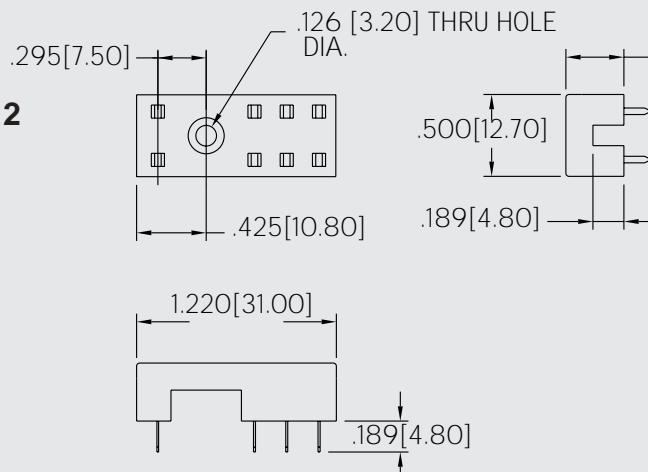

**PC BOARD LAYOUT**

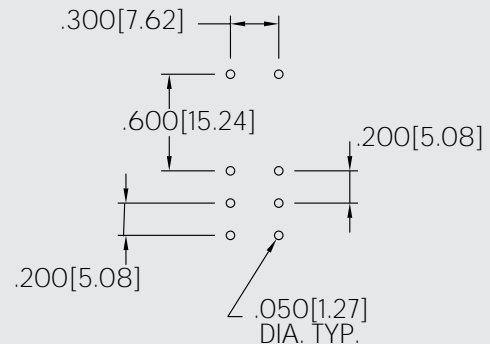

**EC**

# RELAY SOCKET ACCESSORIES

DIN RAIL

DRAWINGS & SPECIFICATIONS

PART NO.

DESCRIPTION

SERIES NO.

C-103-PM

Prepunched Aluminum DIN Rail (1 Meter Lengths)  
(note: Other lengths available, consult factory)

ES, GT, MT, OT, ST

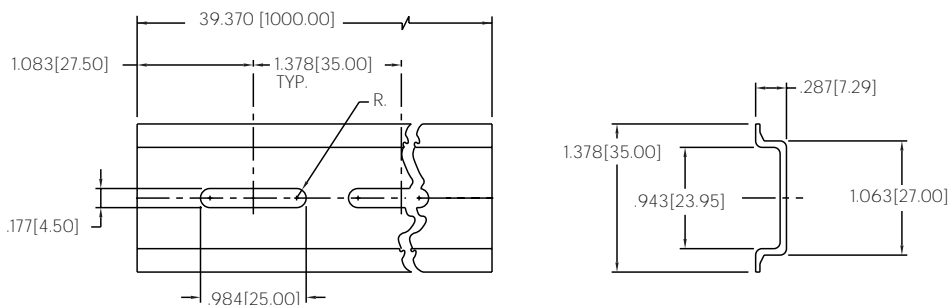

C-104-PM

Prepunched Steel DIN Rail (1 Meter Lengths)  
(note: Other lengths available, consult factory)

ES, GT, MT, OT, ST

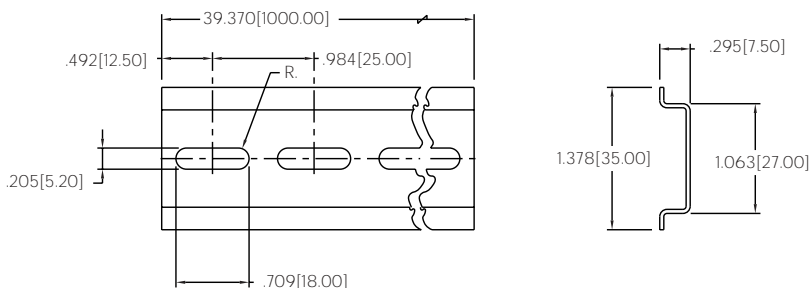

C-105-PM

Prepunched Steel DIN Rail (1 Meter Lengths)  
(note: Other lengths available, consult factory)

ES, GT, MT, OT, ST

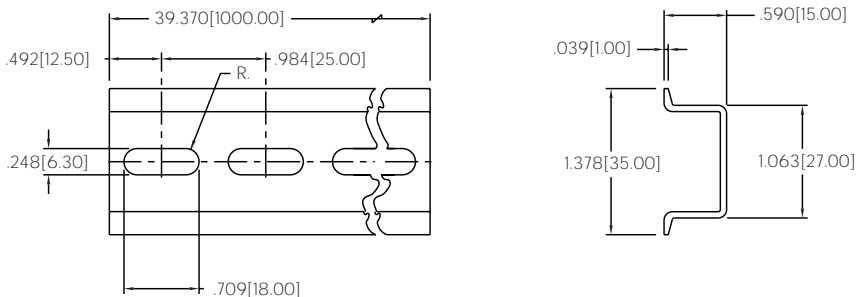

C-106-2PM

Prepunched Steel DIN Rail (2 Meter Lengths)  
(note: Other lengths available, consult factory)

ES, GT, MT, OT, ST

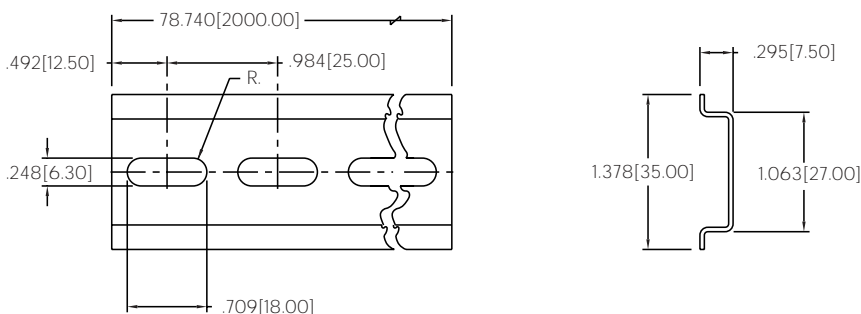

**OTHER STYLES AND HOLE PATTERNS AVAILABLE. CONSULT FACTORY**

# RELAY SOCKET ACCESSORIES

## DRAWINGS & SPECIFICATIONS

### EC SERIES - HOLD DOWN SPRINGS

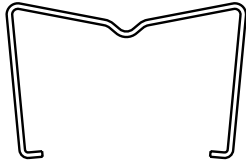

**STEEL SPRING**

MH12-2 - For relays with a height of 12mm  
MH16-2 - For relays with a height of 15 - 16.5mm  
MH25-2 - For relays with a height of 25 - 25.5mm

***NEW!***

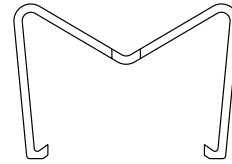

**PLASTIC SPRING**

MP12-2 - For relays with a height of 12mm  
MP16-2 - For relays with a height of 15 - 16.5mm  
MP25-2 - For relays with a height of 25 - 25.5mm

### MARKING PLATES

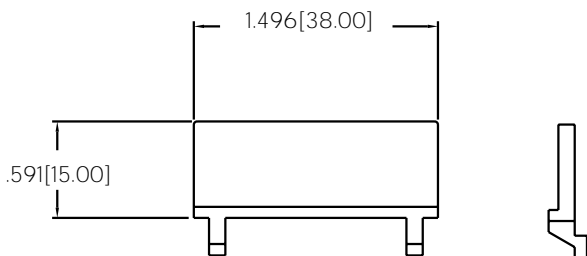

**T FOR ES8, ES11**

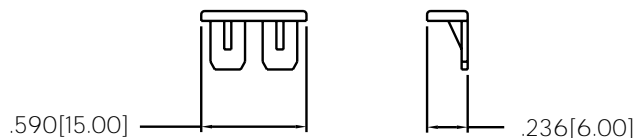

**TR FOR ES35, ES50, ES50/3**

### HOLD DOWN DEVICES /EJECTORS

FOR ES35, ES50, ES50/3, ES15/2N, ES15/3N, ES15/4N

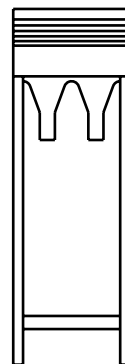
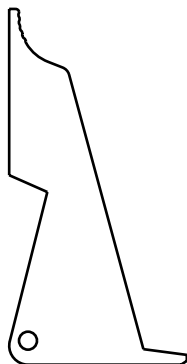

MS12 - For relays with a height of 12mm  
MS16 - For relays with a height of 15 - 16.5mm  
MS25 - For relays with a height of 25 - 25.5mm  
MS35 - For ES15/2N, ES15/3N, ES15/4N