

Greenwich Electronics, Inc.

LD3 Series

- Subminiature package switching 10A
- High sensitivity version available
- High surge resistance (5kV), 3kV dielectric
- Approvals:  pending
- Applications: light duty controls, small appliances, general purpose

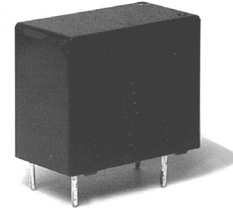

COIL DATA

Nominal Voltage (DC)	Nominal Coil Current (mA) (± 10% at 20°C)		Coil Resistance (Ω) (± 10% at 20°C)	
	Std coil	Sensitive coil (H)	Std coil	Sensitive coil (H)
3	150	67	20	45
5	91	40	55	125
6	75	33	80	180
9	50	23	180	400
12	38	17	320	720
24	19	9	1280	2800
48	9	---	5100	----

Pick-up Voltage	≤75% nominal
Drop-out Voltage	≥5% nominal
Max. Coil Voltage	130% nominal
Coil Consumption	Std: Approx. 0.45W, H: Approx. 0.2W (SPST-NO only)

Contact

Configuration	A: 1 form A (SPST-NO), C: 1 form C (SPDT)
Material	Silver (Ag) alloy
Rated Load	A10: 10A@120VAC, 5A@28VDC / 250VAC Lamp load: 5A@240VAC, 80A inrush AH5/C5: 5A@120VAC, 3A@28VDC / 250VAC
Max. Carry Current	10A
Max. Switching Voltage	30VDC / 277VAC
Max. Switching Current	10A
Max. Switching Power	150W / 1200VA

Greenwich Electronics, Inc.

CHARACTERISTICS

Contact Resistance	Max. 100mΩ
Operate Time	≤8ms
Release Time	≤5ms
Insulation Resistance	100MΩ (@500VDC)
Dielectric Strength:	
• Between coil and contacts	3000VAC - one minute
• Between open contacts	750VAC - one minute
Vibration Resistance	10-55Hz, 1.5mm, double amplitude
Shock Resistance	Min. 10g
Ambient Temperature	
• Operate	-40°C to +70°C
• Storage	-40°C to +125°C
Relative Humidity	45% - 85%
Life Expectancy:	
• Mechanical	1 x 10 ⁷
• Electrical	1 x 10 ⁵ (at rated load)
Weight	Approx. 9 grams

ORDERING INFORMATION

<u>LD3</u>	-	<u>XXX</u>	-	<u>A</u>	<u>H</u>	<u>10</u>	<u>S</u>
I		II		III	IV	V	VI
I.	Series			LD3			
II.	Coil Voltage (VDC)			003, 005, 006, 009, 012, 018, 024			
III.	Contact Configuration			A - 1 form A (SPST-NO), 1 - 1 form C (SPDT)			
IV.	Coil Sensitivity			nil - Standard, H - High Sensitivity			
V.	Contact Rating			5 - 5A, 10 - 10A (SPST-NO std coil only)			
VI.	Package Type			D - Dust Cover, S - Sealed			

Greenwich Electronics, Inc.

LD3 Series Dimensions and Schematics (in mm)

SPST-NO – 1 form A

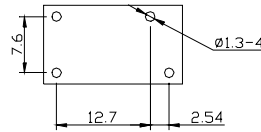
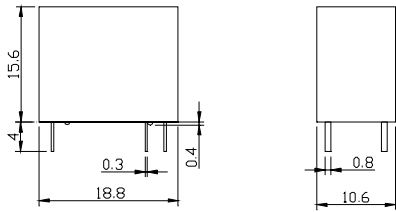

Terminal arrangement and wiring diagram

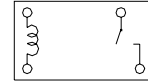

SPDT – 1 form C

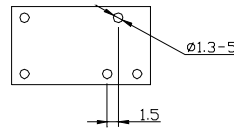
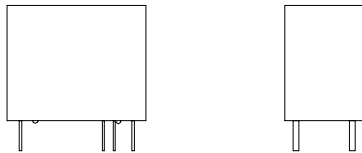

Terminal arrangement and wiring diagram

