

# Greenwich Electronics, Inc.

## LD2 Series

- Subminiature package switching 10A
- High sensitivity version available
- High dielectric (4kV)
- Approvals:  us pending
- Applications: light duty controls, small appliances, general purpose

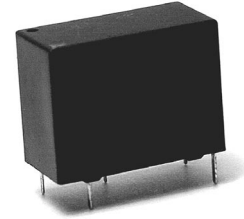

### COIL DATA

Nominal Voltage (DC)	Nominal Coil Current (mA) (± 10% at 20°C)		Coil Resistance (Ω) (± 10% at 20°C)	
	Std coil	Sensitive coil (H)	Std coil	Sensitive coil (H)
3	150	67	20	45
5	91	40	55	125
6	75	33	80	180
9	50	23	180	400
12	38	17	320	700
18	25	11	720	1600
24	19	9	1280	2800

Pick-up Voltage	≤75% nominal
Drop-out Voltage	≥5% nominal
Max. Coil Voltage	130% nominal
Coil Consumption	<b>Std:</b> Approx. 0.45W, <b>H:</b> Approx. 0.2W (SPST-NO only)

### Contact

Configuration	<b>A:</b> 1 form A (SPST-NO), <b>C:</b> 1 form C (SPDT)
Material	Silver (Ag) alloy
Rated Load	<b>NO:</b> 10A@125VAC, 5A 250VAC / 30VAC <b>NC:</b> 3A@30VDC / 250VAC
Max. Carry Current	10A
Max. Switching Voltage	110VDC / 250VAC
Max. Switching Current	10A
Max. Switching Power	150W / 1250VA

# Greenwich Electronics, Inc.

## CHARACTERISTICS

Contact Resistance	Max. 100m $\Omega$ (measured at 1A@240VAC)
Operate Time	$\leq$ 8ms
Release Time	$\leq$ 5ms
Insulation Resistance	1000M $\Omega$ min. (@500VDC)
Dielectric Strength:	
• Between coil and contacts	4000VAC - 50Hz / one minute
• Between open contacts	1000VAC - 50Hz / one minute
Vibration Resistance	10-55Hz, 1.6mm, double amplitude
Shock Resistance	Min. 10g
Ambient Temperature	
• Operate	-40°C to +70°C
• Storage	-40°C to +125°C
Relative Humidity	95%@35°C
Life Expectancy:	
• Mechanical	1 x 10 <sup>7</sup>
• Electrical	1 x 10 <sup>5</sup> (at rated load)
Weight	Approx. 7 grams

## ORDERING INFORMATION

<u>LD2</u>	-	<u>XXX</u>	-	<u>A</u>	<u>H</u>	<u>S</u>
I		II		III	IV	V
I.	Series			<b>LD2</b>		
II.	Coil Voltage (VDC)			<b>003, 005, 006, 009, 012, 018, 024</b>		
III.	Contact Configuration			<b>A - 1 form A (SPST-NO), C - 1 form C (SPDT)</b>		
IV.	Coil Sensitivity			<b>nil - Standard, H - High Sensitivity</b>		
V.	Package Type			<b>D - Dust Cover, S - Sealed</b>		

# Greenwich Electronics, Inc.

## LD2 Series Dimensions and Schematics (in mm)

SPST-NO – 1 form A

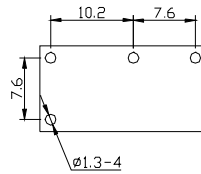
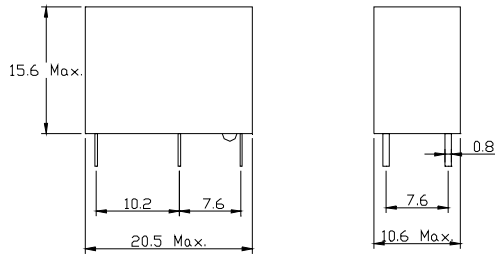

Terminal arrangement  
and wiring diagram

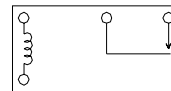

SPDT – 1 form C

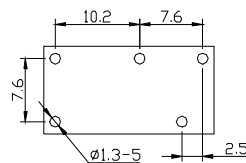
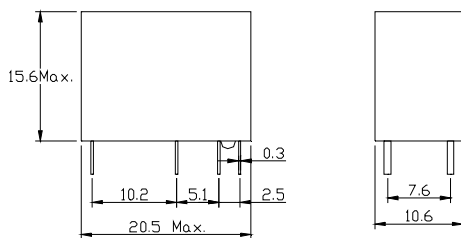

Terminal arrangement  
and wiring diagram

